

CORESINC ACADEMY >

System Integrator Courses

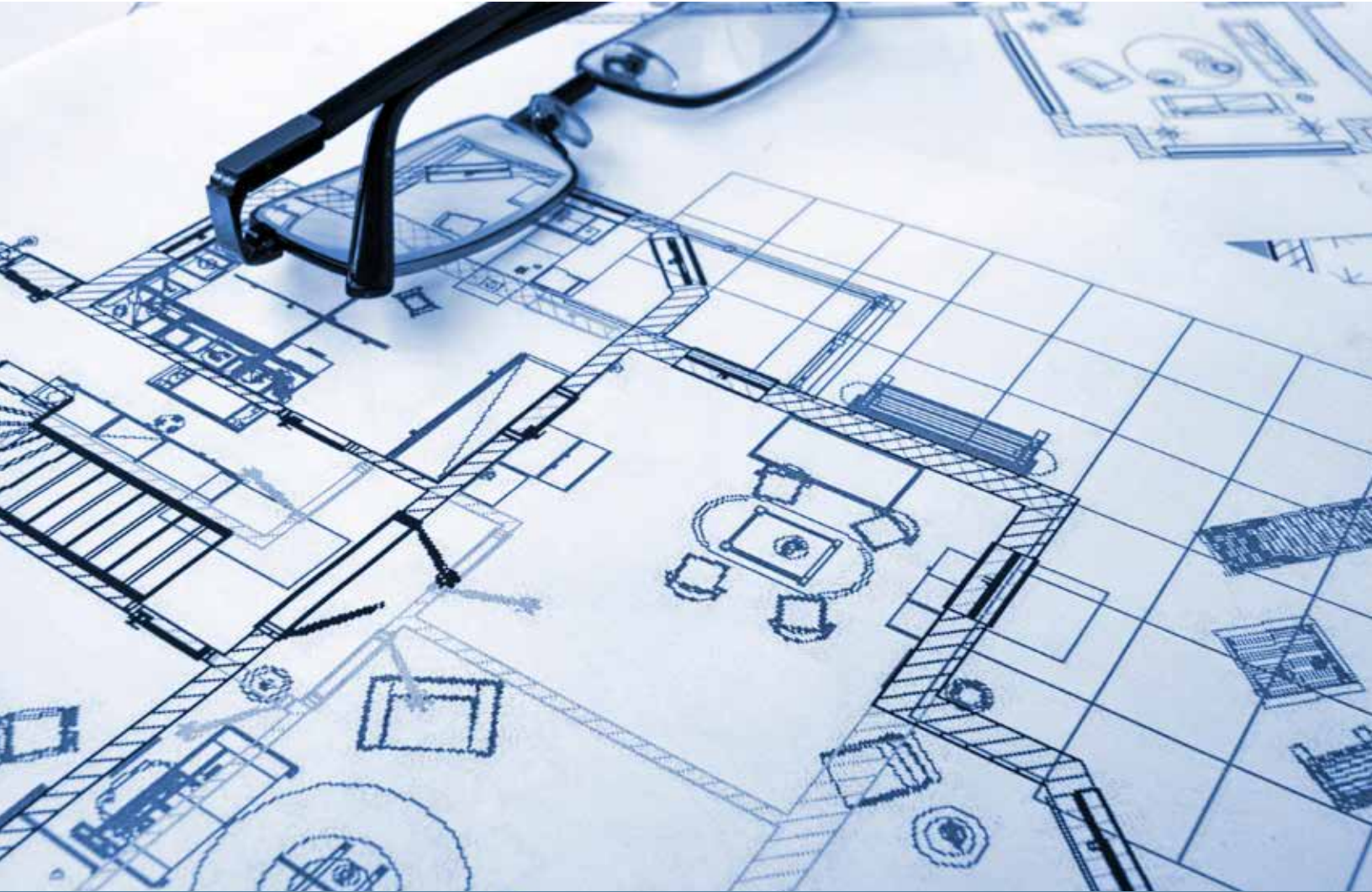

molex

System Integration for Smart Buildings >



CoreSync is a powerful smart building infrastructure that provides a backbone for integrating disparate building functions with standard building management systems. These training courses will enable designers, technicians and programmers to get up to speed quickly on the CoreSync platform so they have all the tools they need to take on a CoreSync smart building project. Gain all three certifications to become a Molex approved Master Integrator.

Courses:

Certification type	Course Code	Pre-Requisites	Format
CoreSync Designer	BP500	Experienced with AutoCAD	6.5 hrs online training 4 online quizzes
CoreSync Technician	BP510	Experienced in Network Systems & Structured Cabling	10 hrs online training 5 online quizzes 1 in-person session*
CoreSync Programmer	BP520	Experienced in System Integration	TBC
CoreSync Master Integrator		Complete all 3 courses	

** Live sessions suspended in some areas due to Covid-19 - check with your local sales or technical team for more information*

System Integrator Training Courses

Course Descriptions >

Certified Designer

This course is for those with Project Engineer, Designer, CAD Engineer roles in engineering, design or consulting firms. Attendees should be PE, RCDD or EIT qualified.

The course covers the CoreSync system, products, and technology in detail on how to properly design the system in AutoCAD.

Becoming a Certified Designer allows you to create Certified Shop Drawings that can be used as CoreSync submittals and installed in the field by a Certified Technician. Unlock full support and maximum warranty coverage from Molex when you complete the course.

After completing certification, you gain access to the complete training course via a manual and access to our AutoCAD MEP plugin for automation of design and documentation.

Certified Technician

This course is intended for Systems Engineers, Low Voltage Contractors, Telecom Contractors and Licensed Electricians. Attendees will need to be experienced in network systems, lighting controls, and structured cabling. A license to work in electrical, telecoms or low voltage is advised.

The course trains technicians in installing CoreSync products from Certified Shop Drawings through commissioning these components into a fully functioning system. Becoming a Certified Technician allows you to install and commission a CoreSync system for a smart building and enables you to unlock full support and maximum warranty coverage from Molex.

After completing certification, you gain access to the complete training course via a manual and access to our Molex Diagnostic Tool software for commissioning.

Certified Programmer

This course is intended for roles such as Systems Engineer, Integrator, AV Technician and Programmer working in firms that specialize in Lighting Solutions, System Integration or AV Solutions. Attendees will need to be experienced in network systems, lighting controls, System Integration, APIs, BACnetIP interface.

The course trains programmers in fully configuring a CoreSync system and gives them the knowledge to connect third party systems via API/BACnet. After completing certification, you gain access to the complete training course via a manual and access to our Molex Diagnostic Tool software for commissioning.

Becoming a Certified Programmer enables you to configure a CoreSync system from scratch and tie in CoreSync in a smart building.

Master Integrator

Becoming a Molex Certified Master Integrator gives you in-depth, 360° knowledge of PoE and the CoreSync smart building platform. Certified Systems Integrators are able to undertake or oversee any aspect of a CoreSync integration project with full support from Molex Connected Enterprise Solutions.

Certified Designer

BP500 Course Modules >

CoreSync Overview: CS100

Estimated Duration: 20 minutes

An introduction to the Internet of Things and the ways CoreSync helps create smart building systems.

Module includes: - Internet of Things (IoT) Applications - CoreSync EcoSystem Alliance - Responsibility at Each Level and role - General System Architecture - Project Lifespan

CoreSync PoE Infrastructure Overview: POE100

Estimated Duration: 30 minutes

An introduction to the terminology and benefits of Power over Ethernet (PoE), and how it relates to the CoreSync solution.

Module Includes: - Understanding PoE Technology - Standards, Classifications and Terminology - Features Supported - CoreSync PoE - PoE Device Power Usage

Quiz: CoreSync PoE Infrastructure Overview

CoreSync Project Overview: PRJ100

Estimated Duration: 35 minutes

This module brings the construction process to life, covering a wide variety of topics critical to a successful project through the lens of the CoreSync system.

Module Includes: - Determining the Project Requirements - Advantages of Utilizing CoreSync - Green Building Requirements - Project Roles and Definitions - Typical Project Timeline - Project Execution

CoreSync Product Overview: PRD100

Estimated Duration: 60 minutes

A high level view of the different software that makes up a CoreSync PoE system, followed by a detailed look at every CoreSync device.

Module Includes: - CoreSync Software - Software Integration Components - Power Sourcing Equipment - Networking / Powered Devices - Fixture Enabling Components - Sensors and Indicators - Special Devices

CoreSync Device Layout & Design Overview: PRD 201

Estimated Duration: 60 minutes

The process of designing CoreSync products from start to finish from the perspective of a designer.

Modules Includes : - System Design Overview - Building Standards and Codes - CoreSync Network Equipment - AutoCAD / Devices - Device Guidelines & Layouts

Quiz: CoreSync Design Layout & Design Overview

CoreSync Device Installation Overview: PRD202

Estimated Duration: 60 minutes

The process of installing CoreSync products from start to finish from the perspective of an installer.

Modules Includes: - Building Standards and Codes and CoreSync compliance - Installation Precautions - Installations and Wiring - Field Testing,

Certified Designer

BP500 Course Modules >

Quiz: CoreSync Device Installation Overview

CoreSync PoE RCP Overview: DWG100

Estimated Duration: 45 minutes

An introduction to project related drawings from the MEP and the Architect explaining how they relate to the successful design and commissioning of a CoreSync system.

Modules Includes: - Architectural Reflected Ceiling Plans - Electrical, Telecom, and Lighting Plans - Luminaire schedules - PoE lighting technology drawing set - Creating & using PoE Gateway Schedules - Expected deliverables and timelines

CoreSync AutoCAD Toolset Installation & Overview: DWG200

Estimated Duration: 60 minutes

Detailed illustration of the Molex AutoCAD MEP library installation and best practices for using this tool to establish a set of CoreSync drawings.

Modules Includes: - CoreSync CAD Standards - Setting up AutoCAD MEP Library and drawing templates - Adding the Molex Catalog to the Content Browser - Overview of the Molex Catalog tool palettes - Using the Project Navigator - Updating AutoCAD schedules - Creating and revising schematic symbols

Quiz: CoreSync AutoCAD Toolset Installation & Overview

Sign up now at
molexces.com/customer-support-portal

Certified Technician

BP510 Course Modules >

CoreSync Overview: CS100

Estimated Duration: 20 minutes

An introduction to the Internet of Things and the ways CoreSync helps create smart building systems.

Module Includes: - Internet of Things (IoT) Applications - CoreSync EcoSystem Alliance - Responsibility at Each Level and role - General System Architecture - Project Lifespan

CoreSync PoE Infrastructure Overview: POE100

Estimated Duration: 30 minutes

An introduction to the terminology and benefits of Power over Ethernet (PoE), and how it relates to the CoreSync solution.

Module Includes: - Understanding PoE Technology Today - Benefits of Using PoE - Terminology, Standards and Classifications - Molex PoE Infrastructure - Features Supported - CoreSync PoE

Quiz: CoreSync PoE Infrastructure Overview

CoreSync Project Overview: PRJ100

Estimated Duration: 35 minutes

This module brings the construction process to life, covering a wide variety of topics all critical to a successful project through the lens of the CoreSync system.

Module Includes: - Determining Project Requirements - Advantages of Utilizing CoreSync - Green Building Requirements - Project Roles and Definitions - Typical Project Timeline - Project Execution

CoreSync Product Overview: PRD100

Estimated Duration: 60 minutes

A high level view of the different software that makes up a CoreSync PoE system, followed by a detailed look at every CoreSync device

Module Includes: - CoreSync Software - Integration Components - Power Sourcing Equipment - Networking / Powered Devices - Local Control Devices - Sensors, Indicators and Special Devices

CoreSync Device Layout & Design Overview: PRD 201

Estimated Duration: 60 minutes

The process of designing CoreSync products from start to finish from the perspective of a designer.

Module Includes: - System Design Overview - Building Standards and Codes - CoreSync Network Equipment - AutoCAD / Devices - Device Guidelines & Layouts

Quiz: CoreSync Design Layout & Design Overview

CoreSync Device Installation Overview: PRD202

Estimated Duration: 60 minutes

The process of installing CoreSync products from start to finish from the perspective of an installer.

Module Includes: - Building Standards and Codes and CoreSync compliance - Installation Precautions - Installations and Wiring - Field Testing,

Certified Technician

BP510 Course Modules >

Quiz: CoreSync Design Installation Overview

CoreSync PoE RCP Overview: DWG100

Estimated Duration: 45 minutes

An introduction to project related drawings from the MEP and the Architect explaining how they relate to the successful design and commissioning of a CoreSync system.

Module Includes: - Architectural Reflected Ceiling Plans - Electrical, Telecom, and Lighting Plans - Luminaire schedules and PoE lighting technology drawing sets - Creating and Using a PoE Gateway Schedule - Expected Deliverables and Timelines

CoreSync Networking Overview: NET100

Estimated Duration: 25 minutes

A walkthrough of the through fundamental networking concepts required by a technician to ensure a successful commissioning process in the field.

Module Includes: - Networking Terms and Definitions - Network Communication and Segmentation - Understanding PoE Implementation for Smart Buildings

CoreSync Commissioning Overview: COM100

Estimated Duration: 60 minutes

A walkthrough of the pre-commissioning, onsite commissioning, and post commissioning actions in sequence to outline the procedure for effectively commissioning the CoreSync system.

Module Includes: - Roles and Responsibilities - Pre-commissioning Documentation - Scheduling and Planning - On-Site Commissioning Outline - Post-Commissioning Training and Support

CoreSync Diagnostic Tool Overview: MDG100

Estimated Duration: 60 minutes

Highlighting an important tool in the commissioning and maintenance of the CoreSync Gateways as well as connected Daisy-Chain devices.

Module Includes: - How to Open MoDiag - Getting Started - How to add a Gateway - How to upgrade any device - Settings tab - Device tab - Project tab - Home tab

Quiz: CoreSync Diagnostic Tool Overview

CoreSync Design Tool Overview: DST100

Estimated Duration: 35 minutes

A comprehensive walkthrough of the vital steps in programming the behavior of the CoreSync system.

Module Includes: - Introduction - Getting Started with Design Tool - Adding Devices - Creating Zones - Finishing up the Design File

Quiz: CoreSync Design Tool Overview

Certified Technician

BP510 Course Modules >

CoreSync Facility Manager Overview: FMT100

Estimated Duration: 35 minutes

This module takes a user through the functionality of the main software interface with a running CoreSync system, guiding commissioners and building operators alike on the application

Module Includes: - Login Screen - Overview page - General Zones tab - User Zones tab - Information Zones tab - Shading Zones tab - Building Control - Configuration Management

Quiz: CoreSync Facility Manager Overview

CoreSync Basic Environment: LAB100

Estimated Duration: 60 minutes

A demonstration of the basics of the CoreSync system and the process of bringing all hardware to life in a fully functioning system.

Module Includes: - Basic Architecture - Molex Devices - Network Configuration / Switches - CoreSync Controller Software - Commissioning Software - Operations Software

CoreSync Live Environment Commissioning

Sign up now at
molexces.com/customer-support-portal

Certified Programmer

BP520 Course Modules >

CoreSync Overview: CS100

Estimated Duration: 20 minutes

An introduction to the Internet of Things and the ways CoreSync helps create smart building systems.

Module Includes: - Internet of Things (IoT) Applications - CoreSync EcoSystem Alliance - Responsibility at Each Level and role - General System Architecture - Project Lifespan

CoreSync PoE Infrastructure Overview: POE100

Estimated Duration: 30 minutes

An introduction to the terminology and benefits of Power over Ethernet (PoE), and how it relates to the CoreSync solution.

Module Includes: - Understanding PoE Technology Today - Terminology, Standards and Classifications - Molex PoE Infrastructure - Features Supported Today - CoreSync PoE - PoE Device Power Usage

Quiz: CoreSync PoE Infrastructure Overview

CoreSync Networking Comprehensive Design

Estimated Duration: TBC

COMING SOON

CoreSync Networking Overview: NET100

Estimated Duration: 25 minutes

A walkthrough of the through fundamental networking concepts required by a technician to ensure a successful commissioning process in the field.

Module Includes: - Networking Terms and Definitions - Network Communication and Segmentation - Understanding PoE Implementation for Smart Buildings

CoreSync Commissioning Overview: COM100

Estimated Duration: 60 minutes

A walkthrough of the pre-commissioning, onsite commissioning, and post commissioning actions in sequence to outline the procedure for effectively commissioning the CoreSync system.

Module Includes: - Roles and Responsibilities - Pre-commissioning Documentation - Scheduling and Planning - On-Site Commissioning Outline - Post-Commissioning Training and Support

CoreSync Design Tool Zoning

Estimated Duration: TBC

COMING SOON

Certified Programmer BP520 Course Modules >

CoreSync Design Tool Configuring

Estimated Duration: TBC

COMING SOON

CoreSync Design Tool Scheduling

Estimated Duration: TBC

COMING SOON

CoreSync Large Scale Project Programming

Estimated Duration: TBC

COMING SOON

CoreSync Programmer course is coming soon -
register your interest at
molexces.com/customer-support-portal

Get started with CoreSync Academy

All our training courses are free to access and accessible 24/7 through our online Customer Support Portal.

To register for access, visit molexces.com/customer-support-portal. Along with standard registration forms, you will also need to complete a mutual NDA.

Once access is granted you will gain access to a range of documentation and online support as well as access to all the course modules.

You can view the courses as many times as you wish. We will update you when courses are updated or new modules are added.

More information on CoreSync: molexces.com/solutions-overview/smart-buildings/

Register & apply for access: molexces.com/customer-support-portal

